



CLiC-it[®] PRO 21

**P.P.E. for continuous
protection**



Revolution

"CLiC-iT provides the answer to a pitfall we have identified on the ground, when workers can find themselves with both the carabiners unhooked.*"

- "Even as a professional, one can be distracted by something which entails a momentary lack of attention.*"
- "As the tests went on, we saw that we would climb faster, allowing us to feel more comfortable and fully focused on our task.*"
- "As managers, we have to make sure our workers are safe and that we comply with general safety rules.*"

Peace of mind

CLiC-iT prevents accidental unhooking and offers continuous protection throughout the progression.

CLiC-iT PRO 21 :

- Compatible with all types of safety cables and anchors (scaffolding, pylons, ladders...) for a vertical or horizontal progression.
- Allows a safer and quicker progression. The handle of the CLiC-iT PRO 21 becomes the natural extension of the hand.
- Ensures total freedom of movement and action.

Confidence

With 9 years of experience and over 10 million users in the leisure sector, CLiC-iT provides the reassurance of tried, tested and approved technology.

CLiC-iT PRO 21 relies on :

- A mechanical system that is simple, ingenious and sturdy
- A 2-year warranty
- Lifetime : 10 years for normal use
- A compliance with standards EN355 (energy absorber), EN354 (lanyards) and EN362 (connectors)

CLiC-iT[®] PRO 21

P.P.E. FOR CONTINUOUS PROTECTION

⊕ Eliminates the risk of accidental stalling

&

⊕ Prevents the user from becoming detached from the lifeline

= Opening one connector automatically locks the other one

+

Only connects to the lifeline

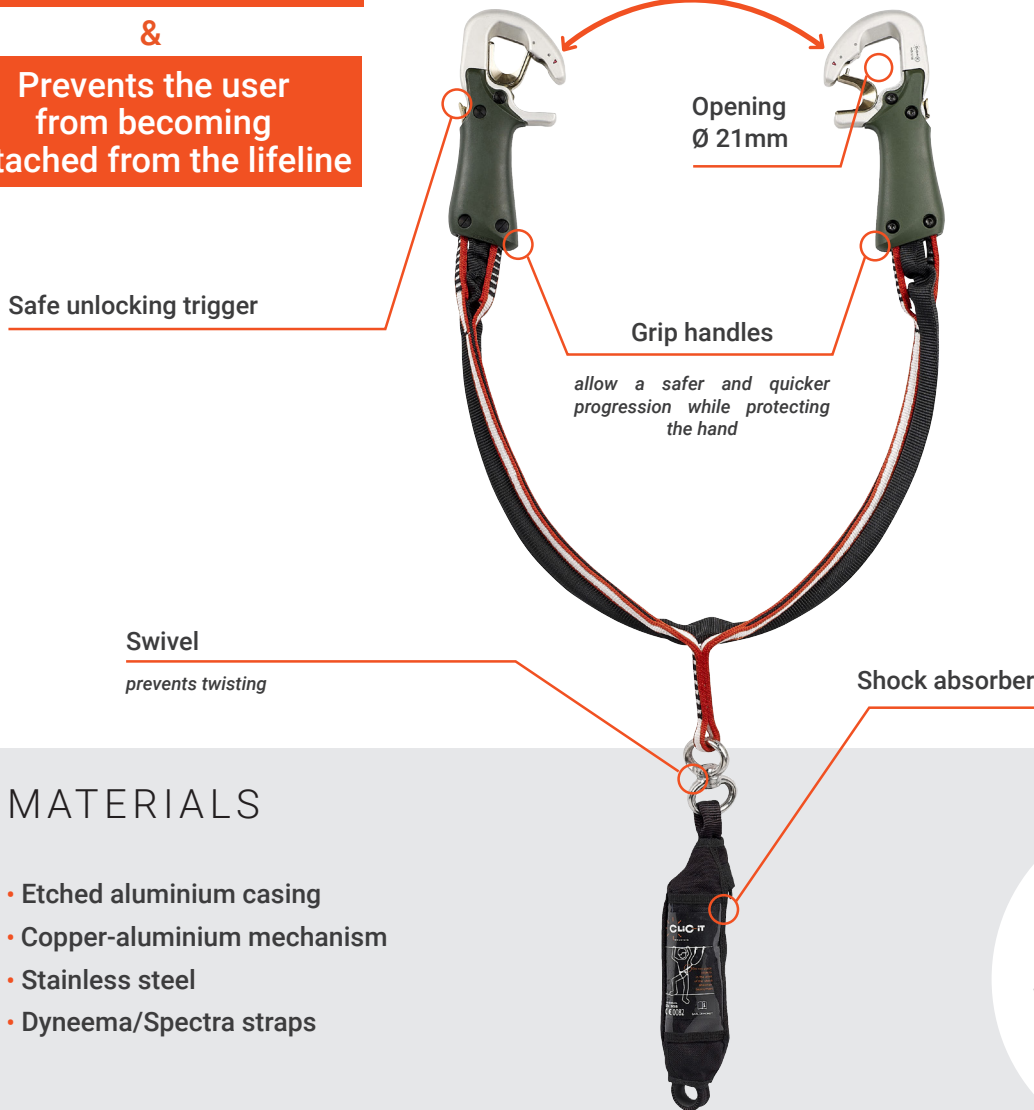

MATERIALS

- Etched aluminium casing
- Copper-aluminium mechanism
- Stainless steel
- Dyneema/Spectra straps

A SOLUTION FOR ALL YOUR NEEDS

P90 21



TYPE OF STRAP	REFERENCE	RANGE	FUNCTIONAL LENGTH
With swivel without shock absorber	P4* 21	148 cm	89 cm
	P5* 21	188 cm	109 cm
With elastic strap + shock absorber	P6* 21	128 cm	135/180 cm
With swivel + shock absorber	P8* 21	128 cm	100 cm
	P9* 21	148 cm	110 cm
	P10* 21	204 cm	138 cm

SUITABLE FOR :

- ✓ Anchor points
- ✓ Cables
- ✓ Ropes

* Metal anchor detection : 0 = without metal anchor detection / 1 = magnet on connector / 2 = magnet on anchor



A WORLDWIDE PRESENCE

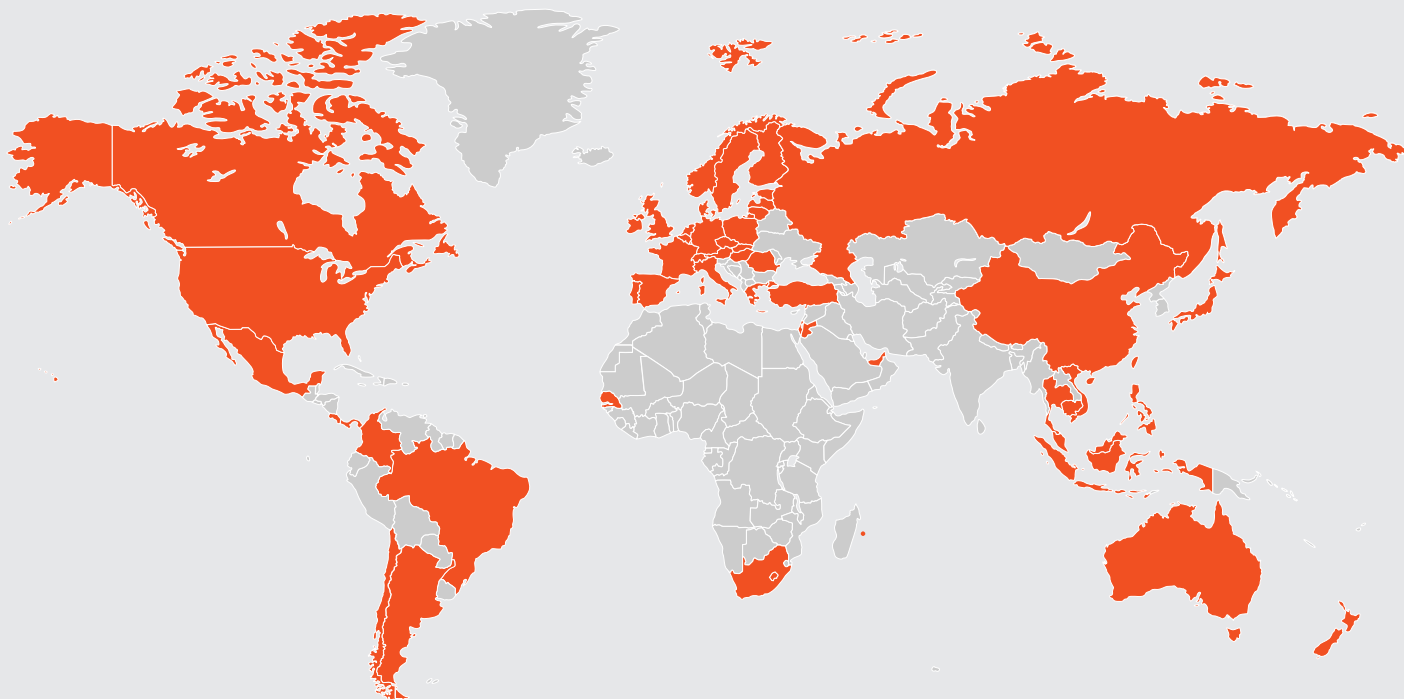

CLiC-it technology is subjected to several patents in France, Europe and the United-States and is registered as an international trademark.

Contact us !

TELEPHONE

+33 (0)3 26 47 11 34

EMAIL

contact@clic-it.eu

ADDRESS

SARL DEHONDT
5 rue des Terres Cellule 7
ZA Croix Blandin
51420 CERNAY-LÈS- REIMS - FRANCE

WWW.CLIC-IT-PRO.EU